

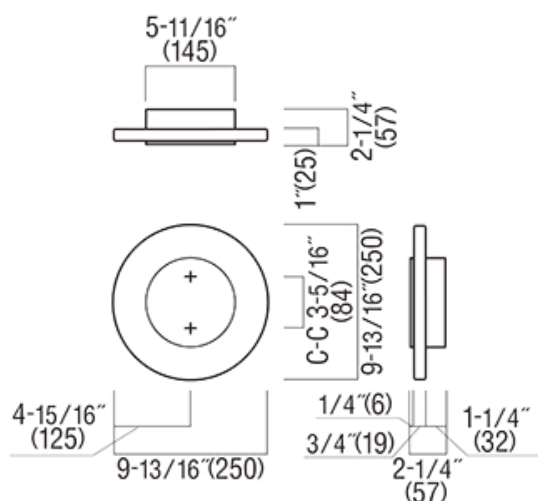

-akatsuki-

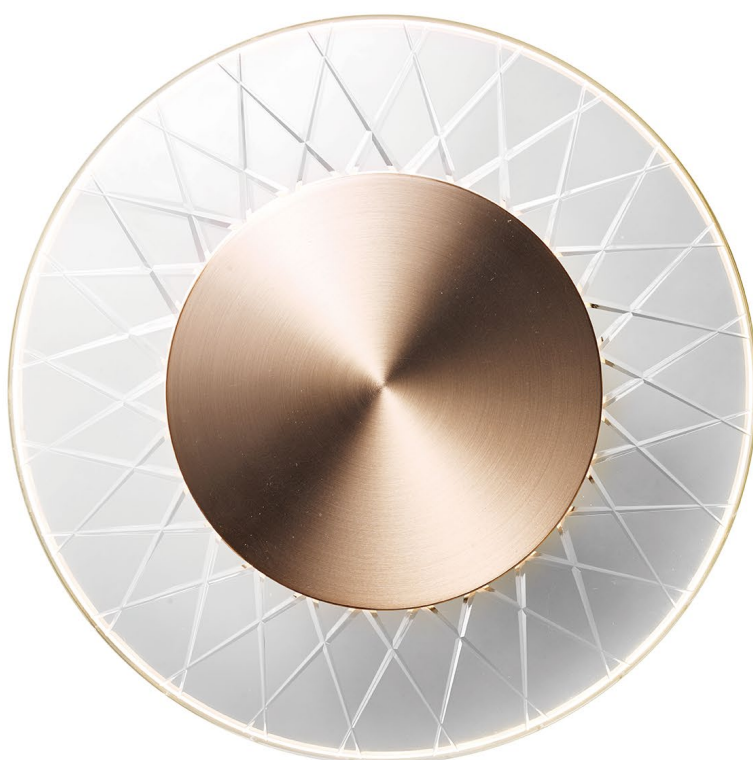

RG1300 -akatsuki- 暁

Kiriko is a technique of making cuts in the surface of glass using a grinder. In fact, it is a very old technique, that has been around for about 200 years.

The characteristic of Edo Kiriko is that it is carved at an acute angle. This is a traditional craft from Tokyo.

And the cut edges are sharp and reflect light well, so I decided to incorporate a LED into the door handle itself to make the cut edges stand out even more beautifully.

Material	stainless steel + glass
Finish	Oxidized gold paint
Length	L=250mm(9-13/16in)
Center to Center	P1=84mm(3-5/16in)
Projection	57mm(2-1/4in)
Caution	As this is a glass product, please avoid strong impact. Please also refrain from using it outdoors.

Romante